

TRIDENT SHOPERIO - FLOOR PLAN

LOWER GROUND FLOOR

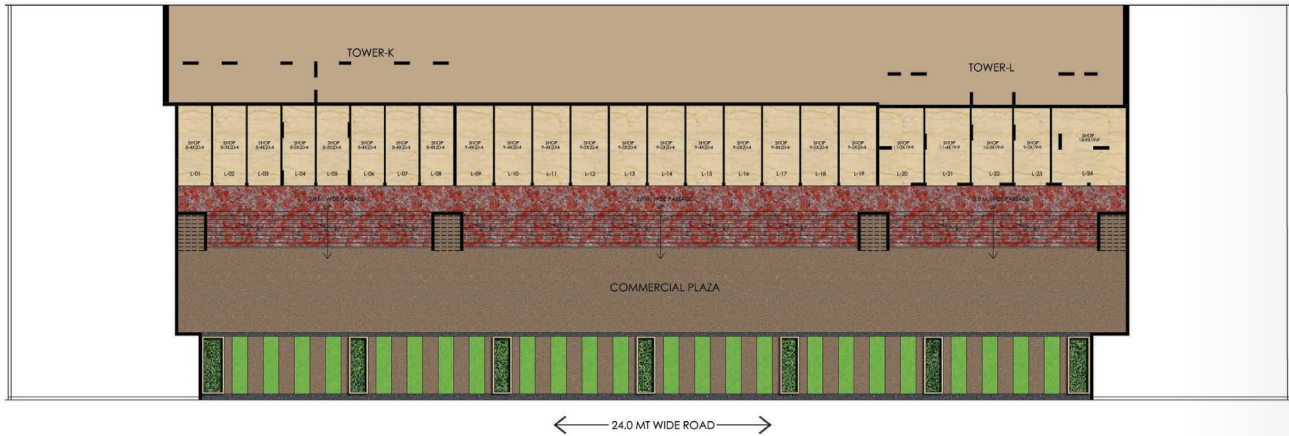

UPPER GROUND FLOOR

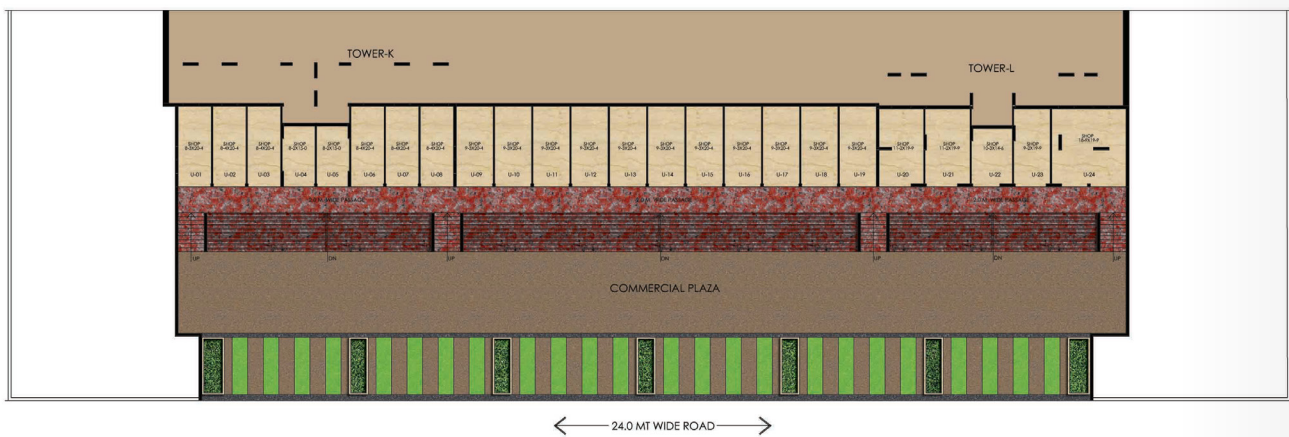

FROM THE HOUSE OF TRIDENT REALTY

TRIDENT
EMBASSY

TRIDENT
EMBASSY-RESO

TRIDENT
SHOPERIO

verona

OSHI

Site Office: Plot No.GH- 05B, Sector-1, Greater Noida, (West) U.P., (India) | Corporate office: 2nd Floor, DLF Centre, Sansad Marg, New Delhi - 110001 (India)

www.tridentrealty.co.in

Promoter RERA No.- UPRERAPRM1568

Projects RERA Phase-1 - UPRERAPRJ6457 | Projects RERA Phase-2- UPRERAPRJ6476 | Projects RERA Phase-3 - UPRERAPRJ6492
Available at : <http://up-rera.in/>

1 Sq.m. = 10.764 Sq.ft. This brochure/PPT/Advertisement is indicative in nature & may not constitute as an offer or invitation for the purpose of registration/booking/sale. Visual and other representations including amenities, specifications in this advertisement are purely indicative and may depict conceptual /artistic impressions and do not constitute a legal offering or binding. Actual product could differ from the above. The viewer /prospective buyer may seek all such information including proforma Buyers' Docs, Sanctioned plans, Approvals, Development Schedule, Specifications, Facilities & Amenities, from the company in respect of the concerned project/Unit that he/she may be interested in, before any such booking/registration, etc. The booking/allotment shall be subject to Application Form, Allotment Letter and Builder Buyer Agreement (referred as Buyer's Docs). Further, details of the project, information thereon and proforma Buyers' Docs are available on the company /site/marketing office(s)and /or company website and on the website of UPRERA @rera-up.in or at its office. Projects RERA Phase-1 - UPRERAPRJ6457 | Projects RERA Phase-2- UPRERAPRJ6476 | Projects RERA Phase-3 - UPRERAPRJ6492 | Available at : <http://up-rera.in/>
Images used in amenities & Features section are stock images, not actual images of the project.